

Project Management Initials: Designer: UH Checked: BMS Approved: KJ
Last saved by: NORFOLKER Last saved by: NORFOLKER
File name: \\UKLD02PP05W01\LEEDS_ENG\ENGINEERING\CURRENT_JOB_FOLDERS\0628270_A629_PHASE 2 HALIFAX08_DRAWINGS\02_ENGINEERING\WORKING\0000 - OVERALL_SITES\0628270-SHT-10-000-C-0008-0009 - ADDITIONAL LAND ACQUISITION REQUIREMENT_1_REV C.DWG

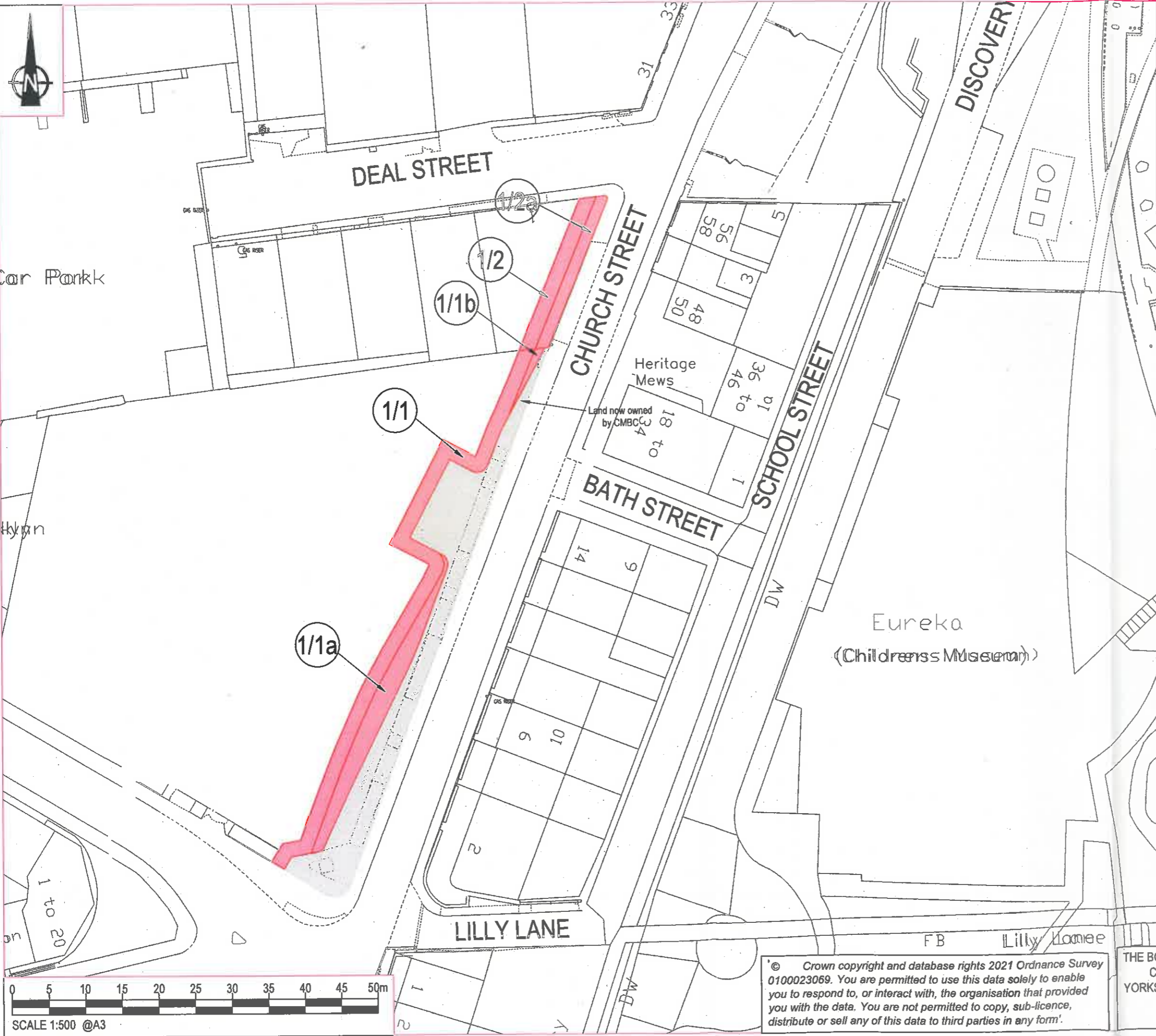

THE CORPORATE COMMON SEAL OF THE BOROUGH COUNCIL OF CALDERDALE was hereunto affixed on the day of *21st October 2021*

in the presence of: *I.R. Hughes*

No. IN SEALING BOOK
251103



NOTES:

KEY:
 LAND TO BE ACQUIRED



© Crown copyright and database rights 2021 Ordnance Survey 0100023069. You are permitted to use this data solely to enable you to respond to, or interact with, the organisation that provided you with the data. You are not permitted to copy, sub-licence, distribute or sell any of this data to third parties in any form.

THE BOROUGH COUNCIL OF CALDERDALE (A629, HALIFAX TOWN CENTRE, HALIFAX) (HIGHWAY IMPROVEMENTS) (WEST YORKSHIRE PLUS TRANSPORT FUND, PHASE 2) SUPPLEMENTAL COMPULSORY ORDER 2021 [SHEET 1 OF 2]
CHURCH STREET - MAP No.1